

Tabela de Volumes					
Estante	Área de Alamo	Área de Corte	Vol Alamo	Vol Corte Acum	Vol Corte Acum
E:0+3.83	0.00	2.86	0.00	0.00	0.00
E:0+10.00	0.00	2.39	0.00	15.89	15.89
E:1+0.00	0.00	2.00	0.00	27.87	37.38
E:1+10.00	0.00	1.36	0.00	16.81	54.18
E:2+0.00	0.00	1.83	0.00	15.84	70.12
E:2+10.00	0.00	1.78	0.00	18.05	88.17
E:3+0.00	0.00	1.39	0.00	16.85	104.02
E:3+2.35	0.00	0.87	0.00	2.45	106.47
E:3+10.00	0.00	0.80	0.00	6.38	113.05
E:3+13.47	0.00	0.87	0.00	3.07	116.12
E:3+18.40	0.00	1.81	0.00	6.29	122.41
E:4+0.00	0.00	2.02	0.00	2.90	125.31
E:4+1.78	0.00	1.46	0.00	3.10	128.41



Tabela de Volumes					
Estante	Área de Alamo	Área de Corte	Vol Alamo	Vol Corte Acum	Vol Corte Acum
E:0+0.00	0.00	3.04	0.00	0.00	0.00
E:0+10.00	0.00	3.02	0.00	35.14	35.14
E:1+0.00	0.00	3.10	0.00	30.82	66.75
E:1+10.00	0.00	2.81	0.00	28.55	89.31
E:2+0.00	0.00	1.65	0.00	21.29	110.59
E:2+10.00	0.00	4.37	0.00	30.10	140.69
E:2+19.49	0.00	3.16	0.00	35.72	176.41
E:3+0.00	0.00	2.77	0.00	1.53	177.93
E:3+3.36	0.00	3.56	0.00	7.26	185.20
E:3+10.00	0.00	3.42	0.00	13.21	198.41
E:4+0.00	0.00	4.58	0.00	35.04	233.44
E:4+10.00	0.00	8.22	0.00	34.03	287.48
E:4+16.02	0.00	7.14	0.00	40.18	327.66



Tabela de Volumes					
Estante	Área de Alamo	Área de Corte	Vol Alamo	Vol Corte Acum	Vol Corte Acum
E:0+0.00	0.00	3.33	0.00	0.00	0.00
E:0+10.00	0.00	3.47	0.00	29.01	29.01
E:1+0.00	0.00	5.49	0.00	44.79	73.81
E:1+2.41	0.00	6.12	0.00	13.97	87.78
E:1+8.00	0.00	3.95	0.00	28.16	115.95
E:1+10.00	0.00	4.11	0.00	8.06	124.02
E:2+0.00	0.00	8.14	0.00	51.23	175.24
E:2+10.00	0.00	3.18	0.00	46.56	221.82
E:2+10.00	0.00	4.02	0.00	35.87	257.69
E:3+10.00	0.00	8.78	0.00	56.87	314.56
E:4+0.00	0.00	13.64	0.00	102.08	416.64
E:4+0.00	0.00	14.27	0.00	8.87	425.58
E:4+5.00	0.00	15.18	0.00	87.41	453.97
E:4+10.00	0.00	8.57	0.00	37.50	531.47
E:5+0.00	0.00	9.25	0.00	89.10	620.57
E:5+10.00	0.00	8.31	0.00	86.77	707.33
E:5+11.63	0.00	10.30	0.00	66.17	773.50
E:5+19.88	0.00	3.89	0.00	25.11	798.61
E:6+0.00	0.00	3.88	0.00	0.53	798.14
E:6+10.00	0.00	3.08	0.00	29.68	827.80
E:7+0.00	0.00	3.84	0.00	28.60	856.40
E:7+10.00	0.00	5.30	0.00	44.74	899.14
E:7+16.83	0.00	7.03	0.00	40.89	940.03
E:8+0.00	0.00	8.22	0.00	22.31	962.34
E:8+6.53	0.00	3.12	0.00	30.32	992.66
E:8+10.00	0.00	3.00	0.00	18.94	1011.59
E:8+12.78	0.00	2.08	0.00	7.70	1019.29
E:9+0.00	0.00	0.50	0.00	11.14	1030.44
E:9+10.00	0.00	1.56	0.00	16.38	1046.82
E:10+0.00	0.00	2.83	0.13	25.93	1062.56
E:10+10.00	0.00	4.83	0.00	36.76	1099.32
E:11+0.00	0.00	5.81	0.00	51.65	1150.97
E:11+10.00	0.00	3.90	0.00	48.91	1199.88
E:12+0.00	0.00	3.21	0.00	35.94	1235.82
E:12+9.28	0.00	3.05	0.00	31.38	1267.20

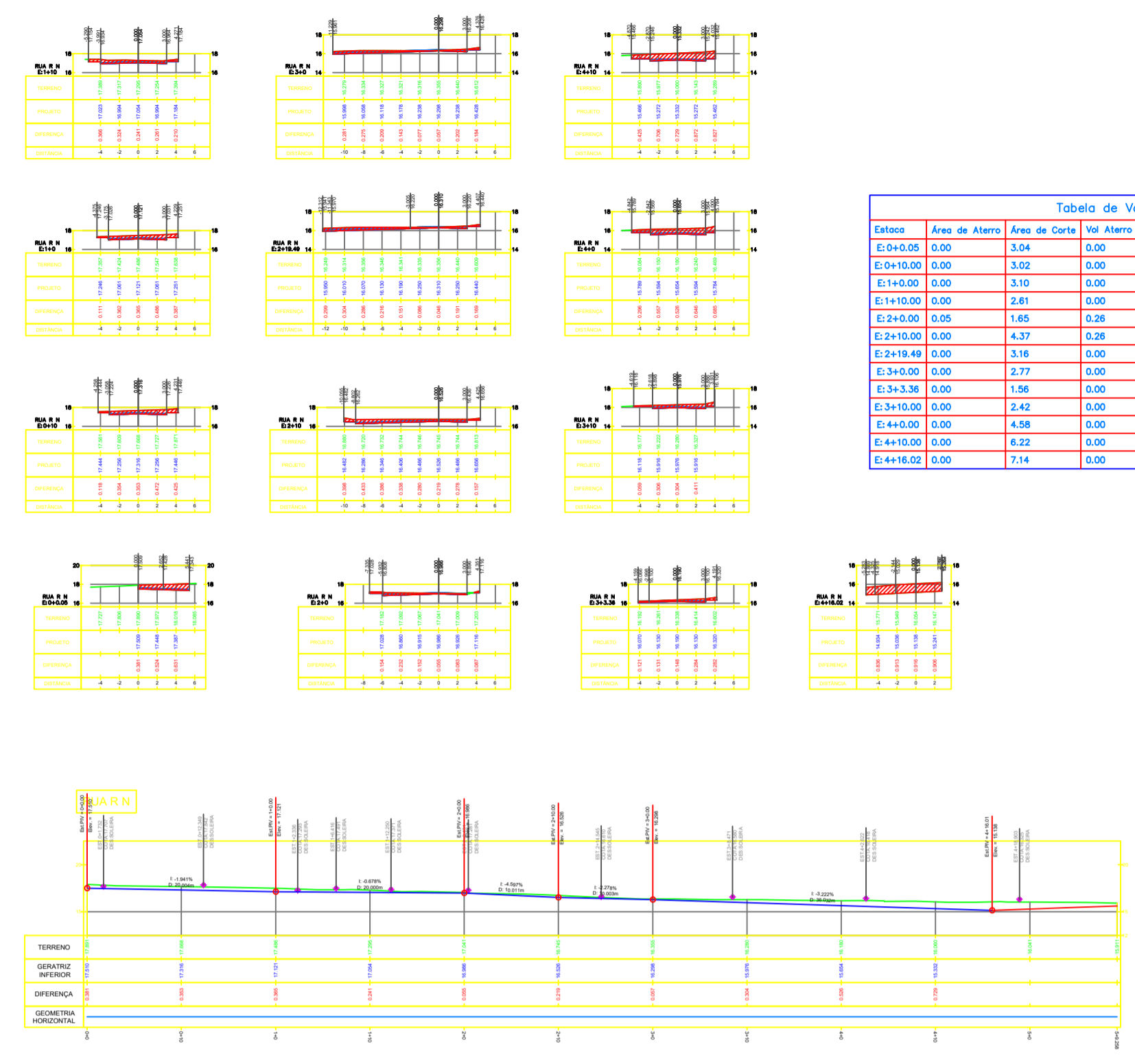

Trav. Sete de Setembro 37, Propriá-SE  
 CEP: 49.900-000  
 Fone: (79)3322-1033

**CONSTRUTORA**  
**Projeto Ltda.**

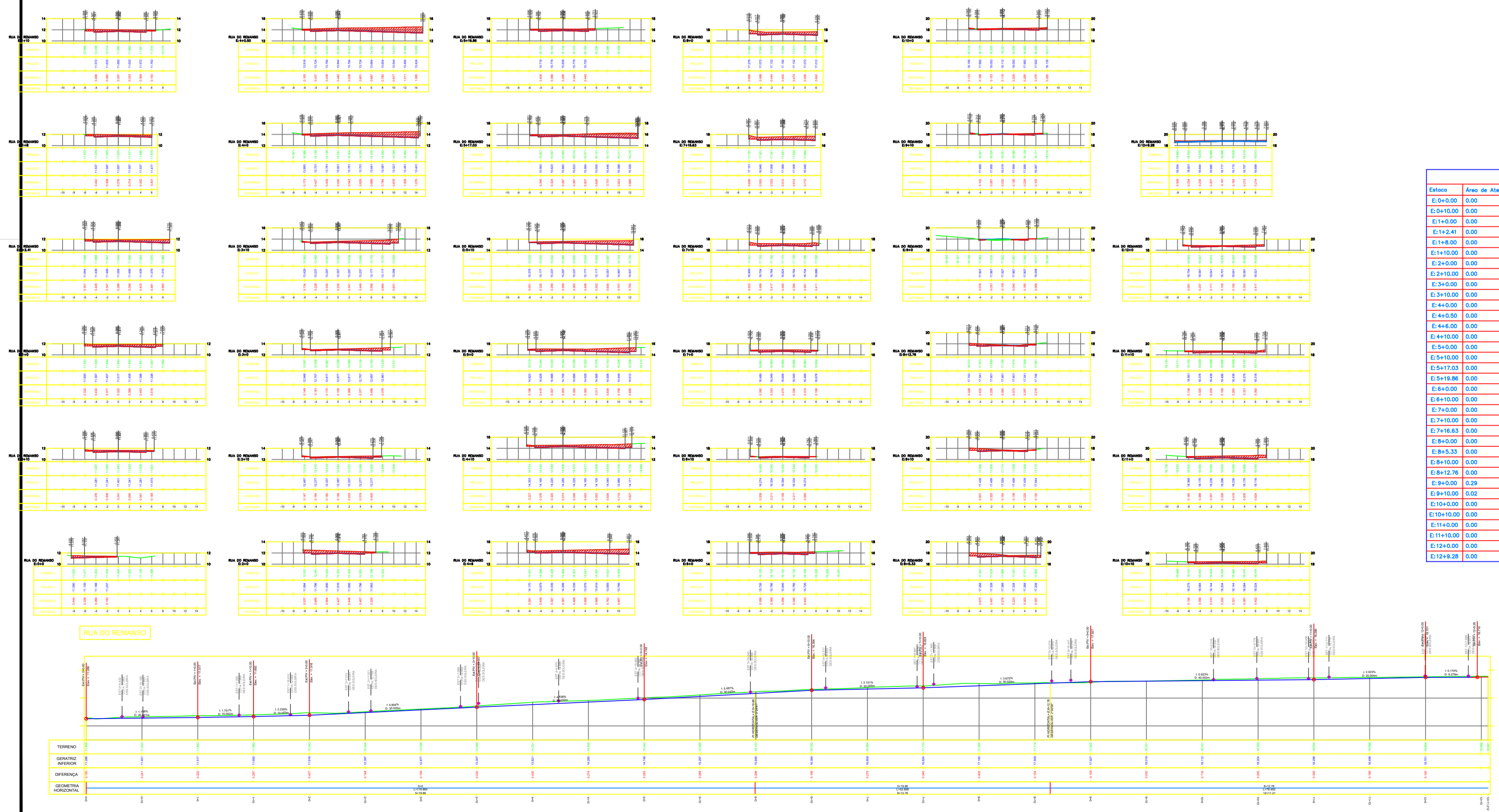
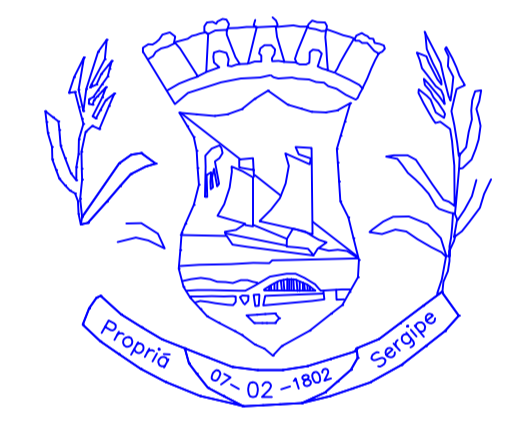
Projetos Topográficos e Construções Ltda.  
 Rua Alto do Santo Antonio nº1149 – CEP: 49.900-000 – Propriá-SE  
 CNPJ: 13.005.210/0001-14 – Ins.Estadual: 27.079.530-8  
 Tel/Fax:(79) 3322-1519/99946-9730  
 Email: construtoraprojetop@yahoo.com.br

PROPRIETÁRIO	VALBERTO DE OLIVEIRA LIMA PREFEITO MUNICIPAL		
PROJETO	CHRISTIANNE DEDA DIAS ENGENHEIRA CIVIL	APROVADO	
RESPONSÁVEL TÉCNICO	FRANCISCO XAVIER NETO ENGENHEIRO CIVIL		
PROPRIETÁRIO	PREFEITURA MUNICIPAL DE PROPRIÁ		
PROJETO	PROJETO DE CORTES E PERFIS DE RUAS		
ENDEREÇO	RUAS DO BAIRRO MARIA DO CARMO PROPRIÁ – SERGIPE		
TÍTULO	IMPLANTAÇÃO		
PROJ.	TOPOGRAFO	DESENHO	FOLHA
APRÓV.	ESCALA 1 : 750		02/03
DATA	OUTUBRO – 2020		