

| Tabela de Volumes | | | | | |
|-------------------|----------------|---------------|-------------|------------|------------------|
| Estatos | Área de Aterro | Área de Corte | Vol. Aterro | Vol. Corte | Vol. Corte Acum. |
| E0+0.00 | 0.05 | 1.11 | 0.00 | 0.00 | 0.00 |
| E0+10.00 | 0.01 | 0.91 | 0.28 | 10.12 | 10.12 |
| E1+0.00 | 0.00 | 1.65 | 0.04 | 12.83 | 22.95 |
| E1+10.00 | 0.00 | 3.98 | 0.00 | 28.13 | 51.08 |
| E2+0.00 | 0.00 | 5.09 | 0.00 | 45.32 | 96.40 |
| E2+8.18 | 0.00 | 5.94 | 0.00 | 45.12 | 141.51 |
| E2+10.00 | 0.00 | 4.76 | 0.00 | 9.73 | 151.25 |
| E2+17.87 | 0.00 | 3.54 | 0.00 | 32.19 | 183.44 |
| E3+0.00 | 0.00 | 4.08 | 0.00 | 8.87 | 192.31 |
| E3+10.00 | 0.00 | 3.03 | 0.00 | 34.73 | 227.04 |
| E3+13.49 | 0.00 | 3.12 | 0.00 | 10.25 | 237.30 |
| E4+0.00 | 0.00 | 2.77 | 0.00 | 18.13 | 255.43 |
| E4+9.31 | 0.00 | 1.97 | 0.00 | 21.03 | 276.46 |
| E4+10.00 | 0.00 | 1.96 | 0.00 | 1.25 | 277.82 |
| E5+0.00 | 0.00 | 2.01 | 0.00 | 19.85 | 297.66 |
| E5+6.02 | 0.00 | 2.83 | 0.00 | 14.57 | 312.23 |
| E5+10.00 | 0.00 | 2.78 | 0.00 | 11.13 | 323.37 |
| E6+0.00 | 0.00 | 4.55 | 0.00 | 36.51 | 359.88 |
| E6+10.00 | 0.00 | 4.10 | 0.00 | 43.21 | 403.08 |
| E6+13.01 | 0.00 | 4.11 | 0.00 | 12.34 | 415.42 |
| E7+0.00 | 0.00 | 3.32 | 0.00 | 25.97 | 441.39 |
| E7+10.00 | 0.00 | 1.94 | 0.00 | 26.30 | 467.69 |
| E8+0.00 | 0.00 | 1.58 | 0.00 | 17.60 | 485.29 |
| E8+10.00 | 0.00 | 1.31 | 0.00 | 14.41 | 499.70 |
| E9+0.00 | 0.00 | 1.48 | 0.00 | 13.93 | 513.63 |
| E9+3.66 | 0.00 | 1.39 | 0.00 | 5.25 | 518.87 |
| E9+10.00 | 0.29 | 1.19 | 1.00 | 7.40 | 526.27 |
| E9+19.81 | 0.07 | 1.91 | 1.90 | 11.70 | 537.97 |
| E10+0.00 | 0.00 | 1.55 | 0.01 | 0.30 | 538.27 |
| E10+10.00 | 0.00 | 1.91 | 0.32 | 16.31 | 554.58 |
| E10+15.95 | 0.00 | 2.07 | 0.00 | 11.72 | 566.30 |
| E11+0.00 | 0.00 | 1.96 | 0.00 | 8.15 | 574.45 |
| E11+10.00 | 0.00 | 2.78 | 0.00 | 23.68 | 598.13 |
| E12+0.00 | 0.00 | 4.33 | 0.00 | 35.57 | 633.70 |
| E12+10.00 | 0.00 | 6.09 | 0.00 | 52.09 | 685.79 |
| E13+0.00 | 0.00 | 6.36 | 0.00 | 62.34 | 748.03 |
| E13+10.00 | 0.00 | 11.57 | 0.00 | 89.67 | 837.70 |
| E13+10.49 | 0.00 | 11.41 | 0.00 | 5.60 | 843.30 |
| E13+17.31 | 0.00 | 18.08 | 0.00 | 100.64 | 943.94 |
| E14+0.00 | 0.00 | 13.98 | 0.00 | 43.03 | 986.98 |
| E14+1.71 | 0.00 | 10.57 | 0.00 | 20.91 | 1007.89 |
| E14+10.00 | 0.24 | 1.59 | 1.01 | 55.42 | 1063.31 |
| E15+0.00 | 0.09 | 0.77 | 1.68 | 11.81 | 1075.12 |
| E15+2.59 | 0.11 | 0.34 | 0.26 | 1.43 | 1076.55 |

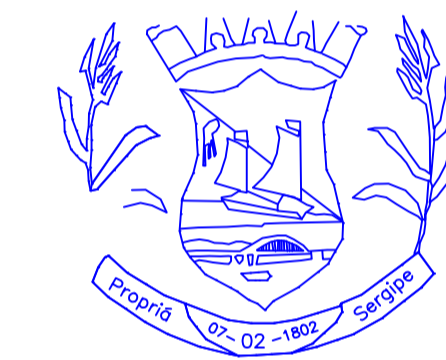
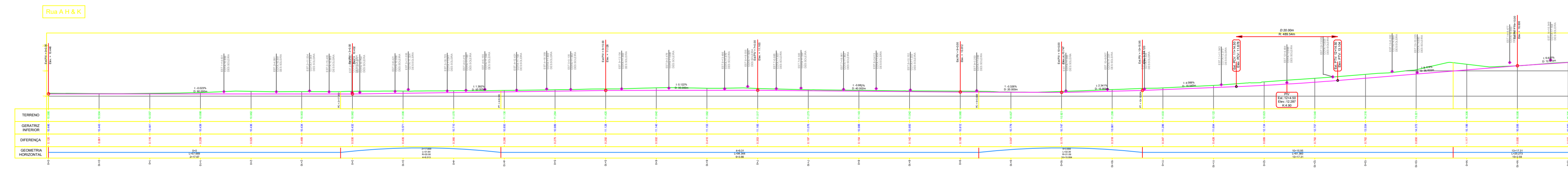

Trav. Sete de Setembro 37, Propriá-SE
 CEP: 49.900-000
 Fone: (79)3322-1033

CONSTRUTORA
Projeto Ltda.
 Projetos Topográficos e Construções Ltda.
 Rua Alto do Santo Antônio nº1149 - CEP: 49.900-000 - Propriá-SE
 CNPJ: 13.005.210/0001-14 - Ins. Estadual: 27.079.530-8
 Tel/Fax: (79) 3322-1519/99946-9730
 Email: construtoraprojetop@yahoo.com.br

| | |
|---------------------|--|
| PROPRIETÁRIO | VALBERTO DE OLIVEIRA LIMA PREFEITO MUNICIPAL |
| PROJETO | CHRISTIANE DEIDA DAS ENGENHEIRA CIVIL |
| RESPONSÁVEL TÉCNICO | FRANCISCO XAVIER NETO ENGENHEIRO CIVIL |
| PROPRIETÁRIO | PREFEITURA MUNICIPAL DE PROPRIÁ |
| PROJETO | PROJETO DE CORTES E PERFIS DE RUAS |
| ENDEREÇO | RUAS DO BAIRRO MARIA DO CARMO PROPRIÁ - SERGIPE |
| TÍTULO | IMPLANTAÇÃO |
| PROJ. | TOPOGRÁFICO |
| APROV. | ESCALA 1:500 |
| DATA | OUTUBRO - 2020 |
| | DESENHO |
| | FOLHA 02/03 |